

Filename: I:\AECOM\NET\COM\LES\ENGLASGOW\JKGLG1DCSPROJECTS\0160709527\_A947\_OBC\0600\_CAD\_GIS\910\_CAD\20-SHEETS\60709527-SHT-C-T2-AT51-GENERAL ARRANGEMENT.DWG  
 Last saved by: JACK.MCKENNA Last Plotted: 2024-04-26

Project Management Initials: Designer: JM Checked: SS Approved: PL ISO A1 594mm x 841mm

KEY	
[Green Line]	NEW KERB LINE
[Grey Area]	FOOTWAY
[Light Grey Area]	CARRIAGEWAY
[Black Line]	BUFFER STRIP
[Purple Area]	SHARED USE FOOTWAY
[Orange Area]	CYCLETRACK
[Black Dashed Line]	NEW WHITE ROAD MARKINGS
[Yellow Dashed Line]	NEW YELLOW ROAD MARKINGS
[Blue Circle]	TRAFFIC SIGNAL
[Yellow Line]	DROPPED KERB
[Pink Line]	DROPPED TRANSITION KERB
[Red Dotted Area]	CONTROLLED TACTILE PAVING
[Green Dotted Area]	UNCONTROLLED TACTILE PAVING
[Blue Dotted Area]	CORDUROY TACTILE PAVING
[Blue Line]	PEDESTRIAN RAILING
[Blue Line]	ACCESSIBLE BUS KERB
[Orange Area]	RAISED TABLE
[Purple Triangle]	PROPOSED SIGNAGE

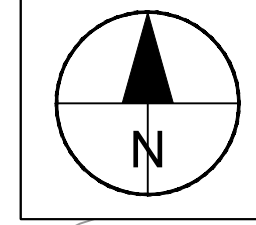

# AECOM

**PROJECT**  
**A947 MULTI-MODAL STUDY - DETAILED APPRAISAL AND OBC**



**CLIENT**

**CONSULTANT**  
 AECOM  
 Aurora  
 120 Bothwell St  
 GLASGOW, G2 7JS  
 +44 (0) 141 248 0300 tel  
 www.aecom.com

- NOTES**
- LAYOUTS PROVIDED ARE SOLELY FOR REPRESENTATIONAL PURPOSES AND DO NOT FORM PART OF A DESIGN PROPOSAL.
  - JUNCTIONS HAVE NOT BEEN CONSIDERED AS PART OF THE FEASIBILITY DRAWINGS AND WILL NEED RE-VISITED IF DESIGN IS TO BE PROGRESSED.

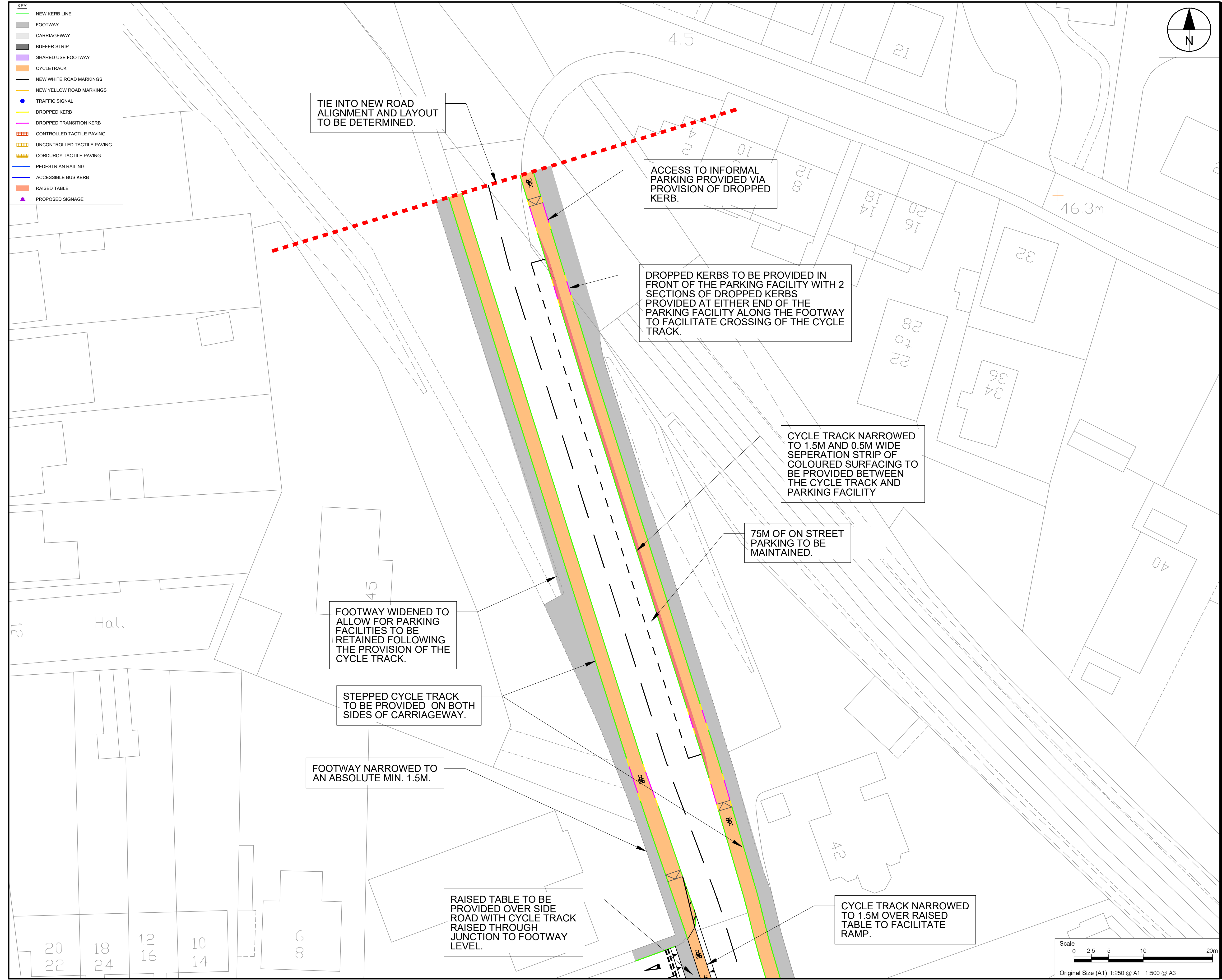

**ISSUE/REVISION**

I/R	DATE	DESCRIPTION

**KEY PLAN**

**PROJECT NUMBER**  
 60709527

**SHEET TITLE**  
 A947 Table 2 Detailed Design  
 AT51 General Arrangement  
 Sheet 1 of 2

**SHEET NUMBER**  
 60709527-SHT-30-C-T2-0713

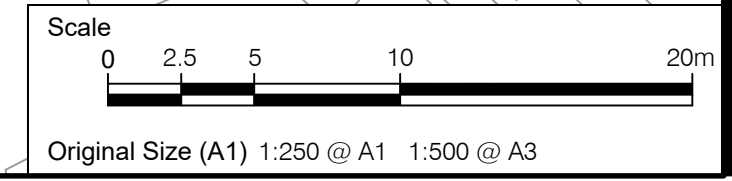

This drawing has been prepared for the use of AECOM's client. It may not be used, modified, reproduced or relied upon by third parties, except as agreed by AECOM or as required by law. AECOM accepts no responsibility, and denies any liability whatsoever, to any party that uses or relies on this drawing without AECOM's express written consent. All measurements must be obtained from the stated dimensions.



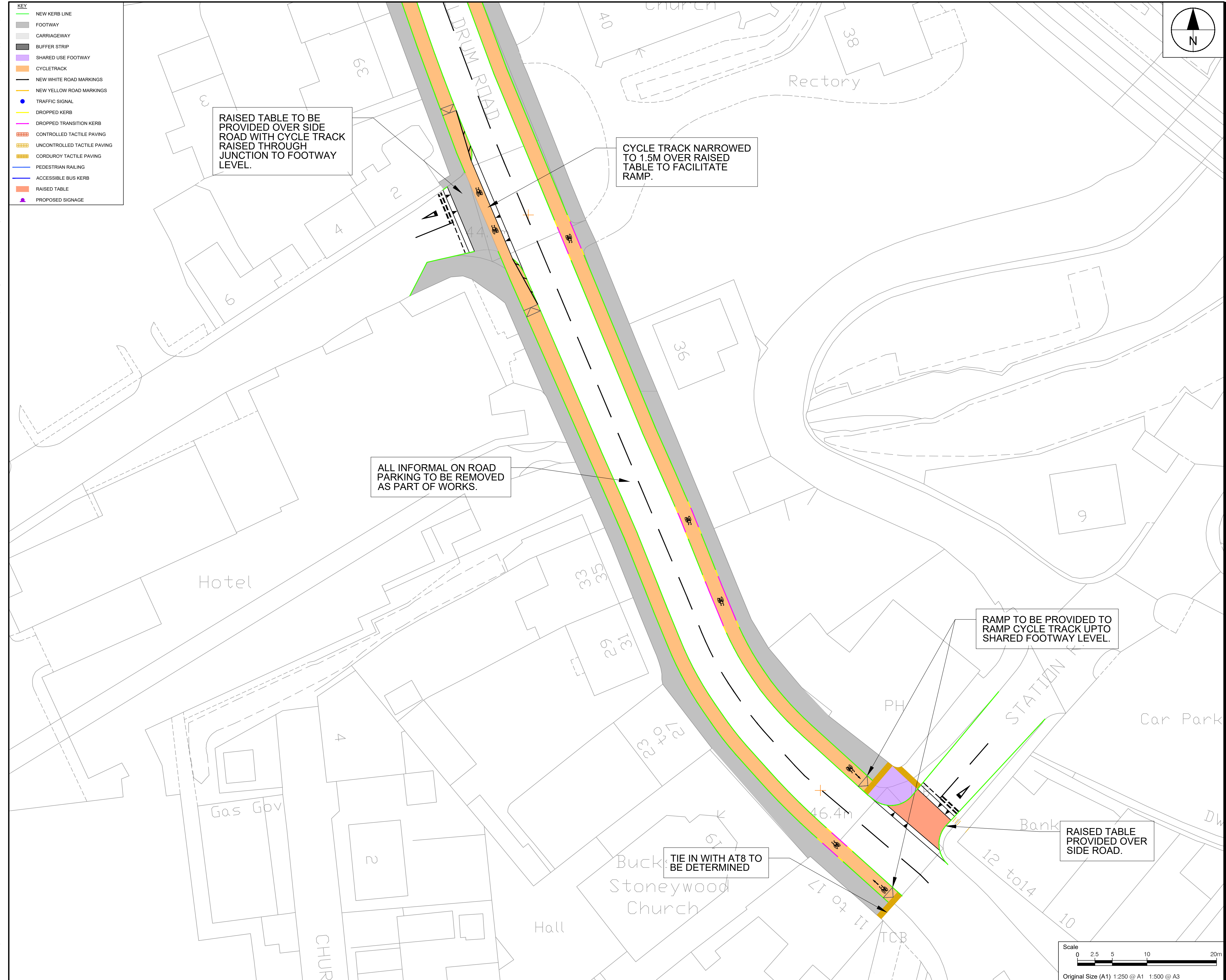

This drawing has been prepared for the use of AECOM's client. It may not be used, modified, reproduced or relied upon by third parties, except as agreed by AECOM or as required by law. AECOM accepts no responsibility, and denies any liability whatsoever, to any party that uses or relies on this drawing without AECOM's express written consent. All measurements must be obtained from the stated dimensions.

**AECOM**

**PROJECT**  
 A947 MULTI-MODAL  
 STUDY - DETAILED  
 APPRAISAL AND  
 OBC



**CONSULTANT**

AECOM  
 Aurora  
 120 Bothwell St  
 GLASGOW, G2 7JS  
 +44 (0) 141 248 0300 tel  
 www.aecom.com

- NOTES**
- LAYOUTS PROVIDED ARE SOLELY FOR REPRESENTATIONAL PURPOSES AND DO NOT FORM PART OF A DESIGN PROPOSAL.
  - JUNCTIONS HAVE NOT BEEN CONSIDERED AS PART OF THE FEASIBILITY DRAWINGS AND WILL NEED RE-VISITED IF DESIGN IS TO BE PROGRESSED.

**ISSUE/REVISION**

I/R	DATE	DESCRIPTION

**KEY PLAN**

**PROJECT NUMBER**  
 60709527

**SHEET TITLE**  
 A947 Table 2 Detailed Design  
 AT51 General Arrangement  
 Sheet 2 of 2

**SHEET NUMBER**  
 60709527-SHT-30-C-0714